

Technical Product Manual

VDO cockpit vision VDO cockpit international

9. Electric Fuel Level Gauge (dia. 52 mm) (Fuel Level Sensor, Tubular Type)

Contents	Page
9.1 General informations	9 - 2
9.2 Technical data	9 - 4
9.3 Tubular type sensors	9 - 6
9.4 Wiring diagram	9 - 8
9.5 Adjustment	9 - 9
9.6 Testing instructions	9 -10
9.7 Instruments survey	9 -12

Installation instructions

999-161-020: VDO cockpit vision
999-161-018: VDO cockpit international

See file 'Installation Instructions (MA)'.

Technical Product Manual

VDO cockpit vision VDO cockpit international

9. Electric Fuel Level Gauge (dia. 52 mm) (Fuel Level Sensor, Tubular Type)

9.2 Technical Data

Operating voltage:	11 ... 16 V or 21.5 ... 30 V
Movement:	System Ke (90°)
Current consumption:	96 mA (without illumination)
Operating temp.:	- 30°C ... + 85°C
Storage temperature:	- 40°C ... + 90°C
Illumination:	1 light bulb 14 V, 3.4 W oder 24 V, 3 W
Protection:	IP64 DIN 40050 from the front reverse-polarity protection
Vibration resistance:	max. 1g eff., 25 ... 2000 Hz, duration 8 h, f: 1 octave/min.
Nominal position:	NL 0 to NL 90, DIN 16257

VDO cockpit international
dia. 52 mm Floodlight



Mounting hole: dia. 53mm

Sensor: tubular type
(not included)

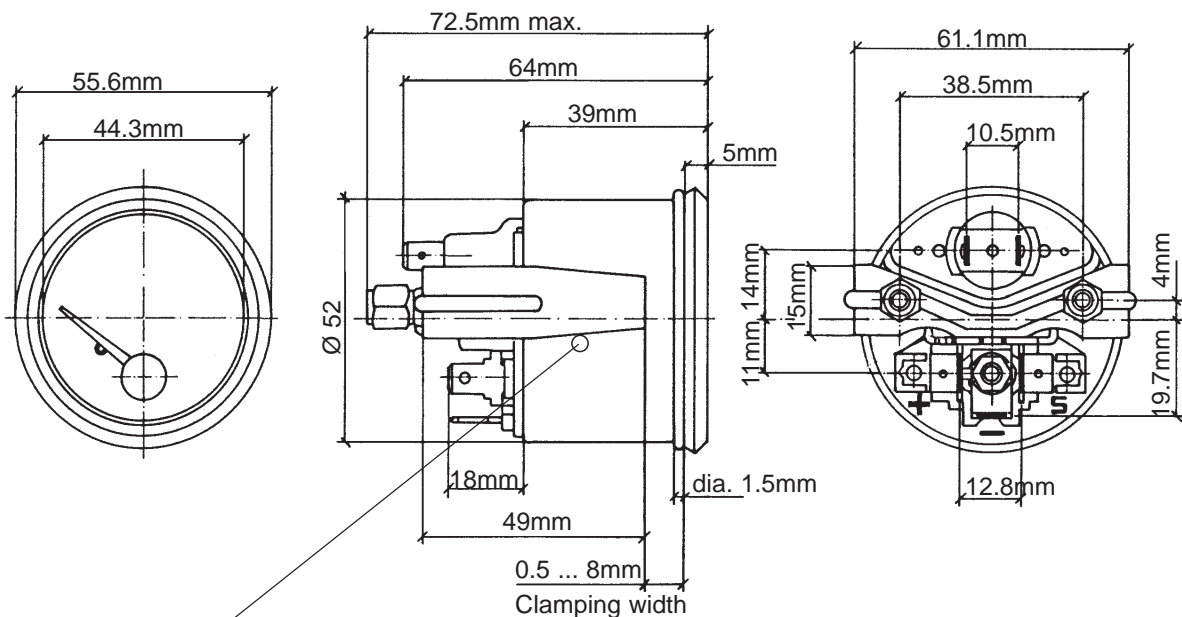

Potentiometer
empty: 60Ω ... 90Ω sensor resistor

Pin assignment:

Pin +: + 12 V or + 24 V
terminal 15

Pin -: Ground, terminal 31

Pin S: Sensor